



## Park Crescent, Worthing

£200,000

This beautiful one-bedroom, Georgian apartment with balcony is located in central Worthing. Laden with several period features, the property is full of character. Park Crescent is situated moments from Worthing Station, ideal for those commuting.

On entering the property from the communal areas, you are welcomed into a bright, spacious entrance hall and office. The room is adorned with delicate corning and lovely wood floors. A pair of ornate, regency style pillars frame the entrance into the reception room. The room is an excellent size, features a wonderful fireplace and large windows with stunning views of Amelia Park. Adjacent is the bedroom, which again is a fantastic size and decorated with a range of period features. Next is the contemporary kitchen with integrated appliances; there is also a modern family bathroom. The property also has a wonderful private South-West facing balcony.

Park Crescent is located in Central Worthing, less than a ten-minute walk from the seafront. The great selection of amenities available on both Rowlands Road and Montague Street can be reached on foot within five minutes. The apartment has brilliant access to public transport, with buses and trains running regularly into Brighton and further afield.



1



1



1



Exempt



Park Crescent, BN11

£200,000

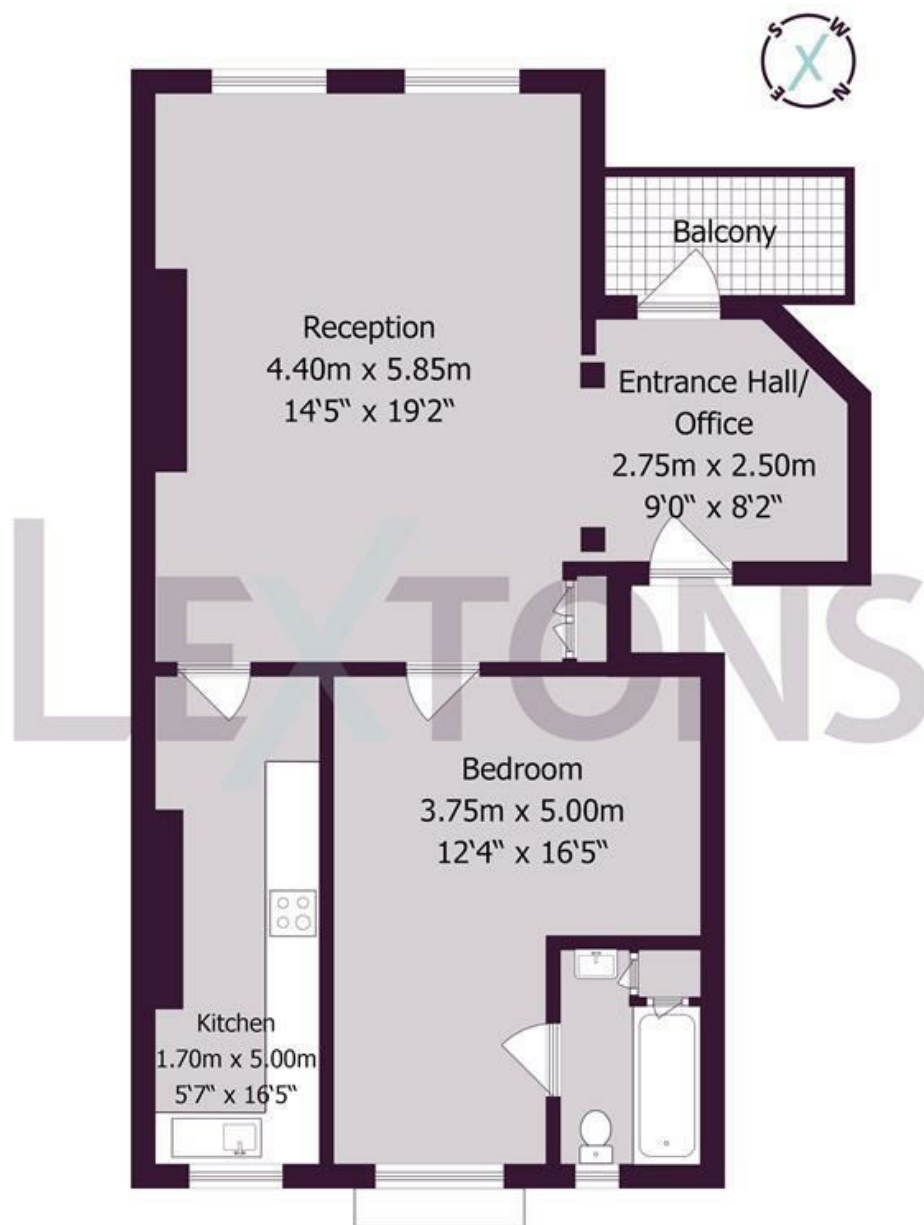

Approximate gross internal floor area 62 sq m/ 667 sq ft

Whilst every care has been taken to ensure accuracy, dimensions are approximate and for illustrative purposes only.

Created by Property Photography UK for Lextons. All rights reserved.

Meet us here...

174 Church Road  
Hove  
BN3 2DJ

We aim to make our particulars both accurate and reliable. However they are not guaranteed; nor do they form part of an offer or contract. If you require clarification on any points then please contact us, especially if you're traveling some distance to view. Please note that appliances and heating systems have not been tested and therefore no warranties can be given as to their good working order.